



□ 18x18x04 mm



Motor: DC single phase brushless motor

Material: Plastic(94V-0)

Bearing: Sleeve bearing

Operation Temperature: -10°C ~ +60°C

Storage Temperature: -20°C ~ +70°C

Weight: 1.74 g / PC

Drawing:

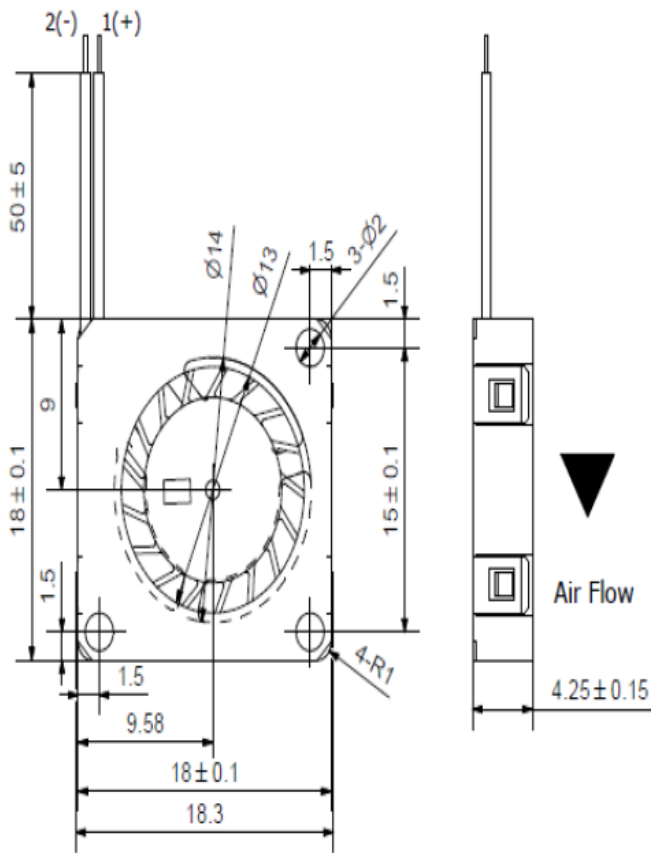

Characteristic Curves

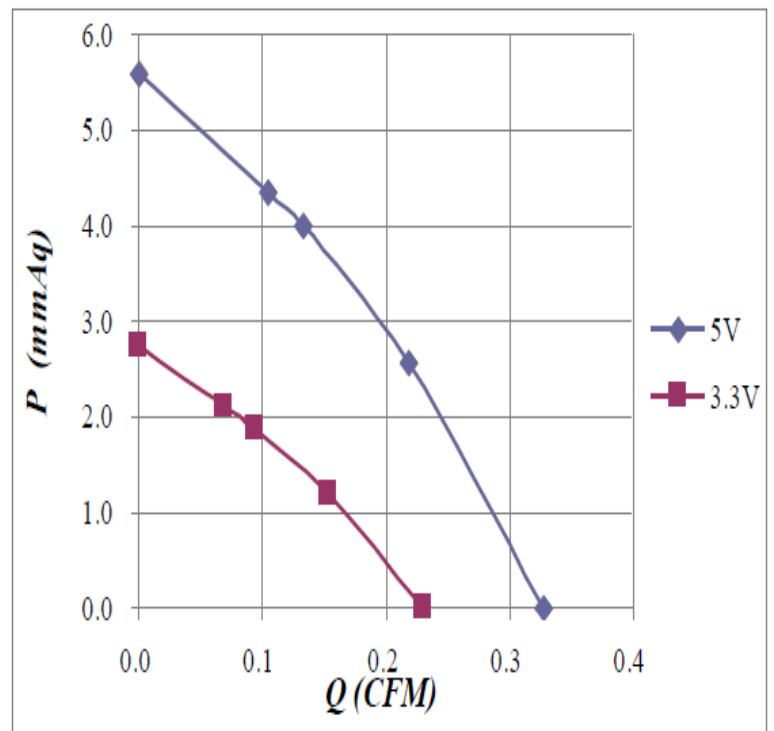

SPECIFICATION

Model	Voltage (V)	Operating Voltage Range(VDC)	Current (A)	Speed (RPM)	Air Flow (CFM)	Pressure (in-H2O)	Noise (dB)
CDB031804	3.3	2.8 – 3.6	0.035	9000	0.23	2.74	15.1
CDB051804	5	4.5 – 5.5	0.050	12000	0.33	5.58	20.4

Micro DC Blower Fan