



ø175x69 mm
(ø6.88x2.71 in)



Material: Plastic impeller

Ambient Temperature Range: -20°C ~ +70°C

Operating Voltage Range: Rated Voltage ±10%

Bearing: Ball bearing (TÜV & UL approval)

Motor Structure: AC Induction Capacitor Motor

Motor protection: Thermal Protected (Auto Restart)

Termination: Lead wire

Weight: 870g / PC

Dimension (units:mm)

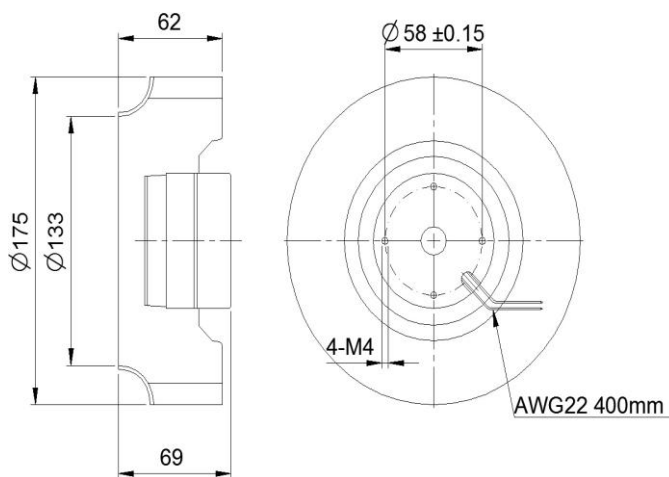

Characteristic Curves

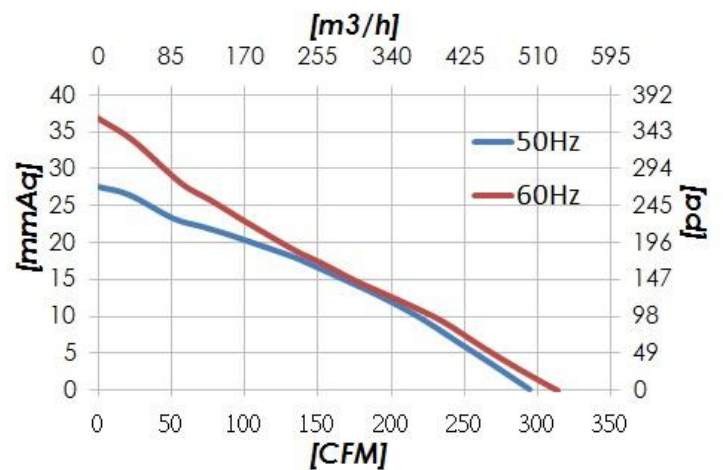

SPECIFICATION

Model	Voltage (V)	Freq. (Hz)	Current (A)	Power (W)	Speed (RPM)	Air Flow (CFM)	Pressure (mm Aq)	Noise (dB)	TÜV UL
CYC11769HB	115	50/60	0.48/0.54	53/63	2600/2900	294/313	28/37	66/68	✓
CYC21769HB	230	50/60	0.22/0.28	52/64	2600/2900	294/313	28/37	66/68	✓