



ø190x72 mm
(ø7.48x2.83 in)



Material: Plastic impeller

Ambient Temperature Range: -20°C ~ +70°C

Operating Voltage Range: Rated Voltage ±10%

Bearing: Ball bearing (TÜV & UL approval)

Motor Structure: AC Induction Capacitor Motor

Motor protection: Thermal Protected (Auto Restart)

Termination: Lead wire

Weight: 1820g / PC

Dimension (units:mm)

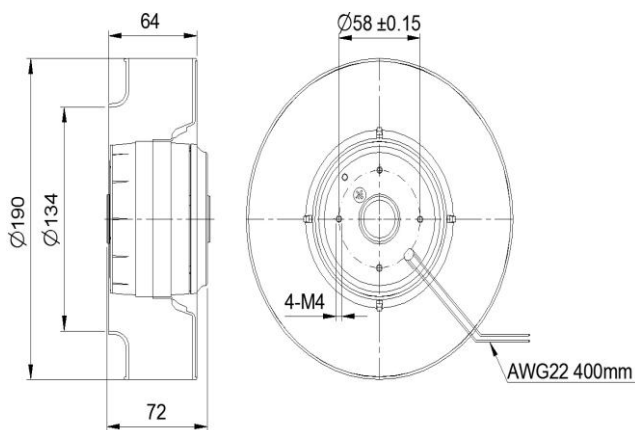

Characteristic Curves

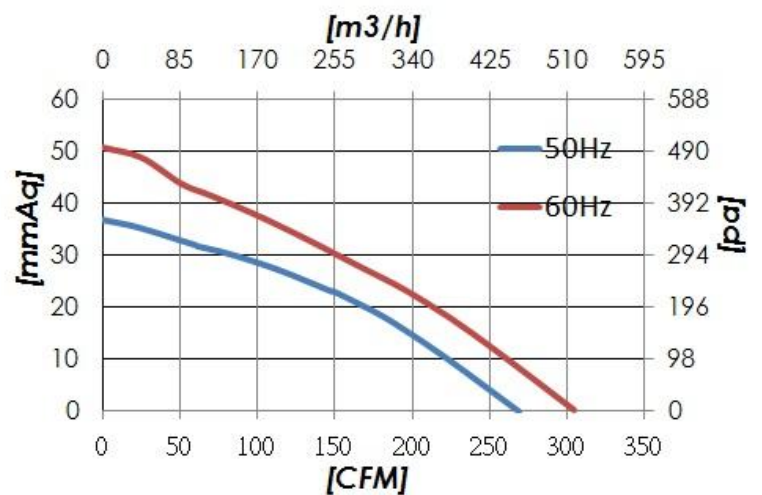

SPECIFICATION

Model	Voltage (V)	Freq. (Hz)	Current (A)	Power (W)	Speed (RPM)	Air Flow (CFM)	Pressure (mm Aq)	Noise (dB)	TÜV UL
CYC11972HB	115	50/60	0.56/0.7	58/80	2700/3100	269/304	37/51	70/73	✓
CYC21972HB	230	50/60	0.26/0.34	58/80	2700/3100	269/304	37/51	70/73	✓