



□ 17x13x08 mm



Frame: Plastic

Impeller: Plastic Material UL94V-0

Operation Temperature Range: -10°C ~ +60°C

Storage Temperature Range: -20°C ~ +70°C

Bearing: Sleeve bearing

Motor Structure: DC Brushless Motor

Package: 2.06g / PC

Dimension (units:mm)

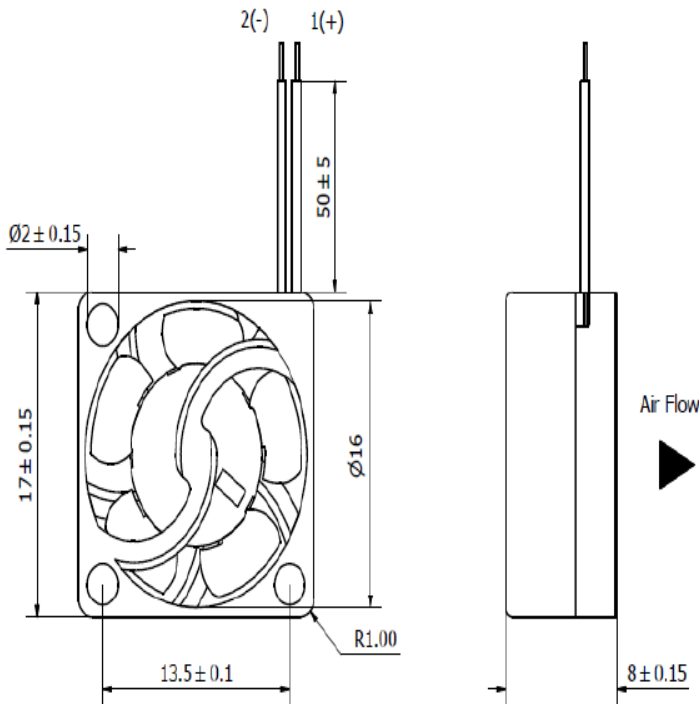

Characteristic Curves

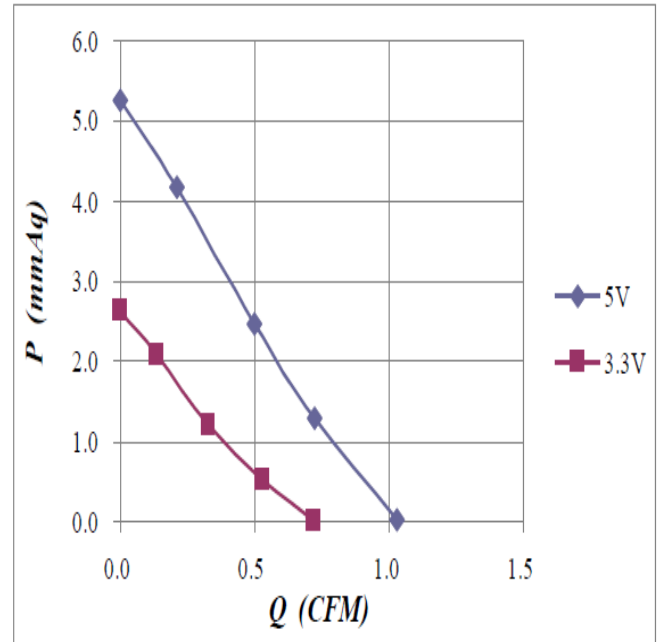

SPECIFICATION

Model	Voltage (V)	Operating Voltage Range(VDC)	Current (A)	Speed (RPM)	Air Flow (CFM)	Pressure (in-H2O)	Noise (dB)
CD031708	3.3	2.8 – 3.6	0.05	11000	0.72	2.63	16.5
CD051708	5	4.5 – 5.5	0.07	16000	1.03	5.26	26.8